

UT | IP54 | U |

가 ,



UT는 U형 보호 캡을 사용하여 케이블의 직경이 4~11mm인 케이블을 보호합니다.

캡의 두께는 1~4mm입니다.

UT는 케이블을 보호하는 데 사용되는 보호 캡입니다.

캡은 케이블을 보호하는 데 사용됩니다. 캡은 케이블을 보호하는 데 사용됩니다.

캡은 케이블을 보호하는 데 사용됩니다. 캡은 케이블을 보호하는 데 사용됩니다. IP54()가 있습니다.



Ausbruch | Cut-out

Gehäuse mit Nut – Federsystem

Housing with tongue and groove system

Wanddicke | Wall thickness
1,0 mm – 4,0 mm

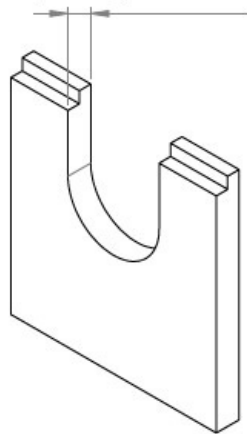

Gehäuse ohne Nut - Federsystem

Housing without tongue and groove system

Wanddicke | Wall thickness
1,0 mm – 4,0 mm

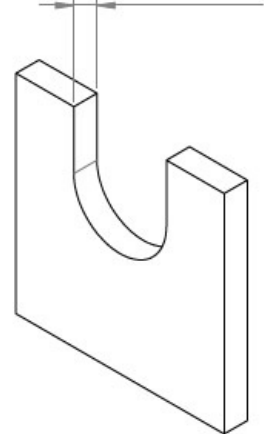

Ausbruch mit Nut

Cut-out with groove

Ausbruch ohne Nut

Cut-out without groove

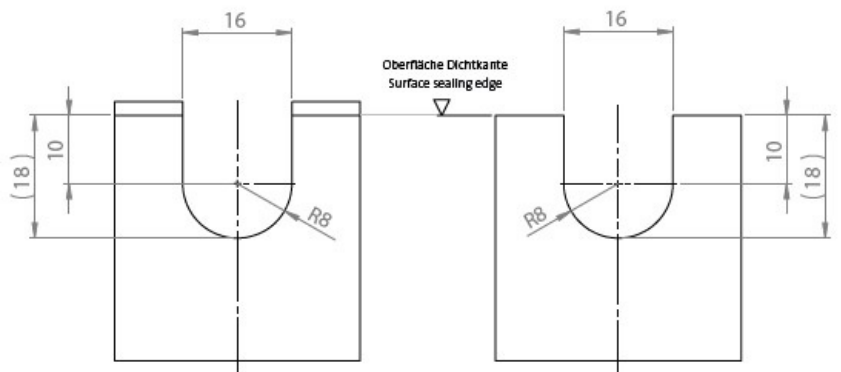

가

- 두께가 2mm인 보호 캡을 사용합니다.
- 가를 사용하여 케이블을 보호합니다.
- 케이블의 직경이 4~11mm인 케이블을 보호합니다.
- 보호 캡은 IP54()를 사용하여 보호합니다.
- 보호 캡은 보호합니다.

| | |
|---------------|------------------|
| IP (EN 60529) | IP54 |
| | |
| | UL94-V0, |
| | -40 C° to 100 C° |
| | UV-, , |
| | |
| | 5 mm |

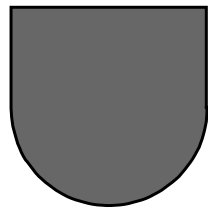

EAN

56100
4251269335464
10
23,5 mm
23 mm
11 mm

□□ □□
□□ □ □□
□□ □ □□

5 mm
1 mm
4 mm

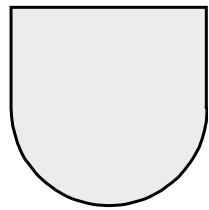

EAN

56000
4251269335396
10
23,5 mm
23 mm
11 mm

□□ □□
□□ □ □□
□□ □ □□

5 mm
1 mm
4 mm
□□(RAL 7035□ □□)

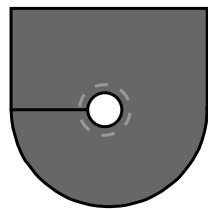

EAN

□□□ □
□□ □□□ □□

56101
4251269335471
10
1
6 mm
23,5 mm
23 mm

□□ □□
□□ □ □□
□□ □ □□

11 mm
5 mm
1 mm
4 mm
1 x 4 - 6 mm

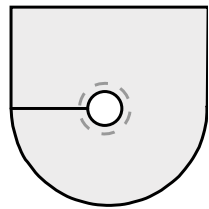

EAN

□□□ □
□□ □□□ □□

56001
4251269335402
10
1
6 mm
23,5 mm
23 mm

□□ □□
□□ □ □□
□□ □ □□

11 mm
5 mm
1 mm
4 mm
□□(RAL 7035□ □□)
1 x 4 - 6 mm

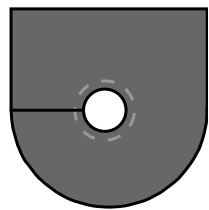

EAN

□□□ □
□□ □□□ □□

56102
4251269335488
10
1
7 mm
23,5 mm
23 mm

□□ □□
□□ □ □□
□□ □ □□

11 mm
5 mm
1 mm
4 mm
1 x 5 - 7 mm

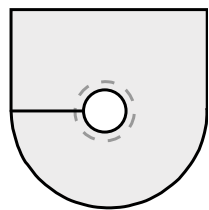

EAN

□□□ □
□□ □□□ □□

56002
4251269335419
10
1
7 mm
23,5 mm
23 mm

□□ □□
□□ □ □□
□□ □ □□

11 mm
5 mm
1 mm
4 mm
□□(RAL 7035□ □□)
1 x 5 - 7 mm

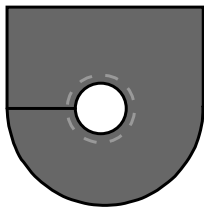

EAN

□□□ □
□□ □□□ □□

56103
4251269335495
10
1
8 mm
23,5 mm
23 mm

□□ □□
□□ □ □□
□□ □ □□

□□□ □□ □

11 mm
5 mm
1 mm
4 mm

1 x 6 - 8 mm

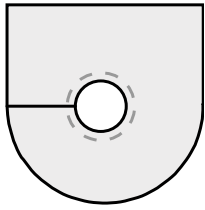

EAN

□□□ □
□□ □□□ □□

56003
4251269335426
10
1
8 mm
23,5 mm
23 mm

□□ □□
□□ □ □□
□□ □ □□

□□□ □□ □

11 mm
5 mm
1 mm
4 mm

□□(RAL 7035□ □□)
1 x 6 - 8 mm

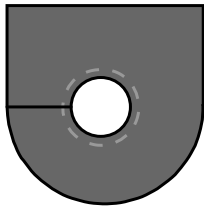

EAN

□□□ □
□□ □□□ □□

56104
4251269335501
10
1
9 mm
23,5 mm
23 mm

□□ □□
□□ □ □□
□□ □ □□

□□□ □□ □

11 mm
5 mm
1 mm
4 mm

1 x 7 - 9 mm

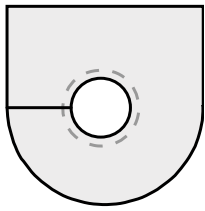

EAN

□□□ □
□□ □□□ □□

56004
4251269335433
10
1
9 mm
23,5 mm
23 mm

□□ □□
□□ □ □□
□□ □ □□

□□□ □□ □

11 mm
5 mm
1 mm
4 mm

□□(RAL 7035□ □□)
1 x 7 - 9 mm

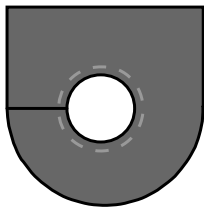

EAN

□□□ □
□□ □□□ □□

56105
4251269335518
10
1
10 mm
23,5 mm
23 mm

□□ □□
□□ □ □□
□□ □ □□

□□□ □□ □

11 mm
5 mm
1 mm
4 mm

1 x 8 - 10 mm

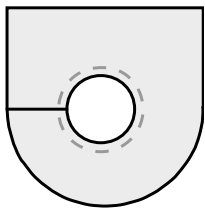

EAN

□□□ □
□□ □□□ □□

56005
4251269335440
10
1
10 mm
23,5 mm
23 mm

□□ □□
□□ □ □□
□□ □ □□

□□□ □□ □

11 mm
5 mm
1 mm
4 mm

□□(RAL 7035□ □□)
1 x 8 - 10 mm

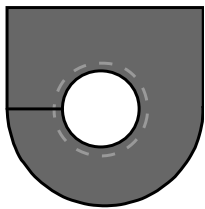

EAN

□□□ □
□□ □□□ □□

56106
4251269335525
10
1
11 mm
23,5 mm
23 mm

□□ □□
□□ □ □□
□□ □ □□

□□□ □□ □

11 mm
5 mm
1 mm
4 mm

1 x 9 - 11 mm

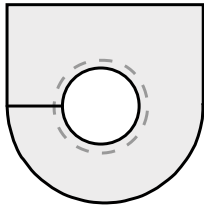

EAN

□□□ □
□□ □□□ □□

56006
4251269335457
10
1
11 mm
23,5 mm
23 mm

□□ □□
□□ □ □□
□□ □ □□
□□□ □□ □

11 mm
5 mm
1 mm
4 mm
□□(RAL 7035□ □□)
1 x 9 - 11 mm

icotek[®]
smart cable management